

重载压力传感器

Pressure sensor

RPT8300 系列

应用于工程机械、船舶、高速列车、化工、航空、采矿、医疗、冶金、电力等领域

- 性能稳定，优异的 EMC 性能
- 通过高低温、盐雾、温湿度测试
- 抗高频震动、冲击
- 防护等级可达 IP67
- 符合 RoHS, CE 认证
- 符合防爆要求
- 可定制开发特殊型号



外形尺寸图 Dimensions

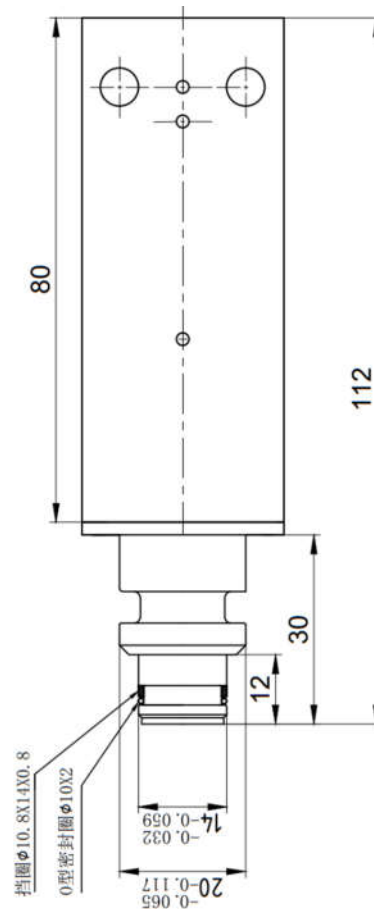
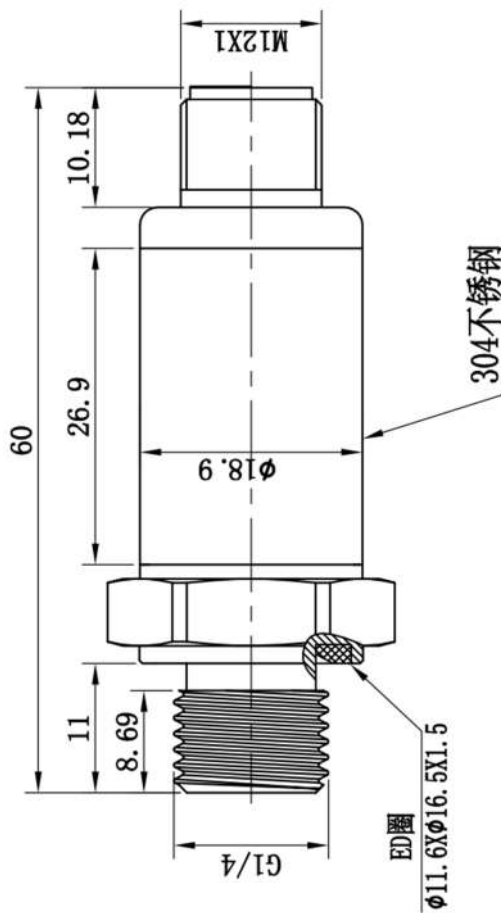

技术参数 Technical Parameter

参数	Specifications	技术指标 Technical Data				
输入数据	Input Data					
压力范围	Measuring ranges	0~1...10...16...25...50...100...250...400...600...6000 bar				
过载压力	Overload pressures	300%F.S		150%F.S		
爆破压力	Burst pressures	500%F.S		300%F.S		
机械接口	Mechanical connection	G1/4-A	M20*1.5	1/4-18NPT/NPTF	G3/8- A	G1/2
锁紧扭力	Torque value	20N.m	30N.m	35N.m	20N.m	30N.m
介质接触物	Parts in contact with medium	Mech connection:Stainless steel			Seal:FKM 17-4PH	
输出数据	Output data					
输出信号	Output signal	4~20mA	485	1~5V	I2C	1~10V 0.5~4.5V
精度	Accuracy to DIN 16086	≤±0.25%F.S trp		≤±0.5%F.S trp		
	Max.setting	≤±0.5%F.S max		≤±1%F.S max		
非线性	Non-linearity at max.setting	≤±0.3%F.S max		≤±0.3%F.S max		
	To DIN16086					
迟滞性	Hysteresis	≤±0.25%F.S max				
重复精度	Repeatability	≤±0.25%F.S				
压力上升时间	Rise time	≤1 ms				
响应时间	Response time	≤0.5ms				
长期稳定性	Long-term drift	≤±0.1%F.S trp./year				
环境条件	Environmental conditions					
温度补偿	Compensated temperature range	-25~+85℃				
工作温度	Operating temperature range	-40~+125℃				
储存温度	Storage temperature range	-40~+135℃				
流体温度	Fluid temperature range	-40~+125℃				
EMC 抗干扰	EMC Test	EN 6100-4-2/3/4/5				
耐振性	Vibration resistance to	≤30g				
	DIN EN 60068-2-6 at 10~2000Hz					
冲击	Impact	50g				
负载	Load	RL ≥ 5kΩ				
防护等级	Protection class to DIN 40050	IP67, IP68				
其他数据	Other data					
工作方式	Operational Mode	绝压, 表压 Absolute, Gage				
工作电压	Operating voltage	24VDC(9~32VDC)	3~3.6VDC	5±0.5VDC		
供电电流	Power supply current	<10mA				
极性保护	Polarity protection	≥32VDC	≥28VDC(5±10%VDC 供电压力传感器)			
耐电压保护	Resistance to voltage protection	≥50VDC	≥28VDC(5±10%VDC 供电压力传感器)			

RPT8300-系列 压力传感器



选型表 Model code

RPT83 X X-X-XX-XXXX-X(000)

电气接口 Electrical connection

- 0=flying lead
- 1=M12X1 EN60947-5-2
- 2=3 pole+PE,DIN43650,male
- 3=Round Packard Metri-Pack
- 5=客户定制

机械接口 Mechanical connection

- 1=7/16-20UNF-2A
- 2=G1/2-A DIN3852(male)
- 3=1/4-18NPT
- 4=G1/4-A DIN3852-E
- 5=G1/2-A
- 6=G3/8-A
- 7=M14*1.5
- 8=M20*1.5
- M=客户定制

输出信号 Signal

- A=4~20mA,2conductor
- B=485,4conductor
- C=1~10V,3conductor
- D=1~5V,3conductor
- E=I2C,4conductor
- M=客户定制

精度 Precision

- 02=0.25%
- 05=0.5%

压力范围 (bar) Pressure ranges in bar

- 0001=0~1bar
- 0050=0~50bar
- 0400=0~400bar
- 6000=0~6000bar
- (压力范围 0~6000bar 可选)

工作方式 Operational Mode

- A=绝压 Absolute
- G=表压 Gage

导线 Modifcation number

- 000=不带连接线
- 020=2m 电缆线 (含接头)
- 050=5m 电缆线 (含接头)

M12X1 4-pole male

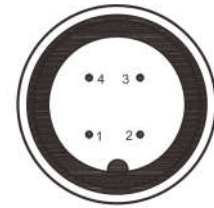

Pin	RPT831X-A	RPT831X-C
1	+24VDC	+24VDC
2	n.c.	1~10VDC
3	4~20mA	GND
4	n.c.	n.c.

DIN43650

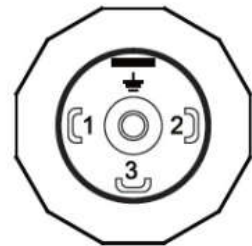

Pin	RPT832X-A	RPT832X-C
1	+24VDC	+24VDC
2	4~20mA	1~10VDC
3	n.c.	GND
Grounding	PE	

Flying lead

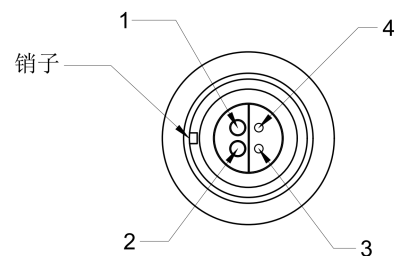

Pin	RPT83MM
1	+12VDC
2	0.5~4.5VDC
3	n.c.
4	GND